

# Android V

DESIGN DANIEL LIBESKIND



Kcal = Watt x 0.860  
BTU = Watt x 3.413

Watt  $\Delta t$  60° = Watt  $\Delta t$  50° x 1.264  
Watt  $\Delta t$  40° = Watt  $\Delta t$  50° x 0.750  
Watt  $\Delta t$  30° = Watt  $\Delta t$  50° x 0.517  
Watt  $\Delta t$  20° = Watt  $\Delta t$  50° x 0.307

p max = 5.0 bar

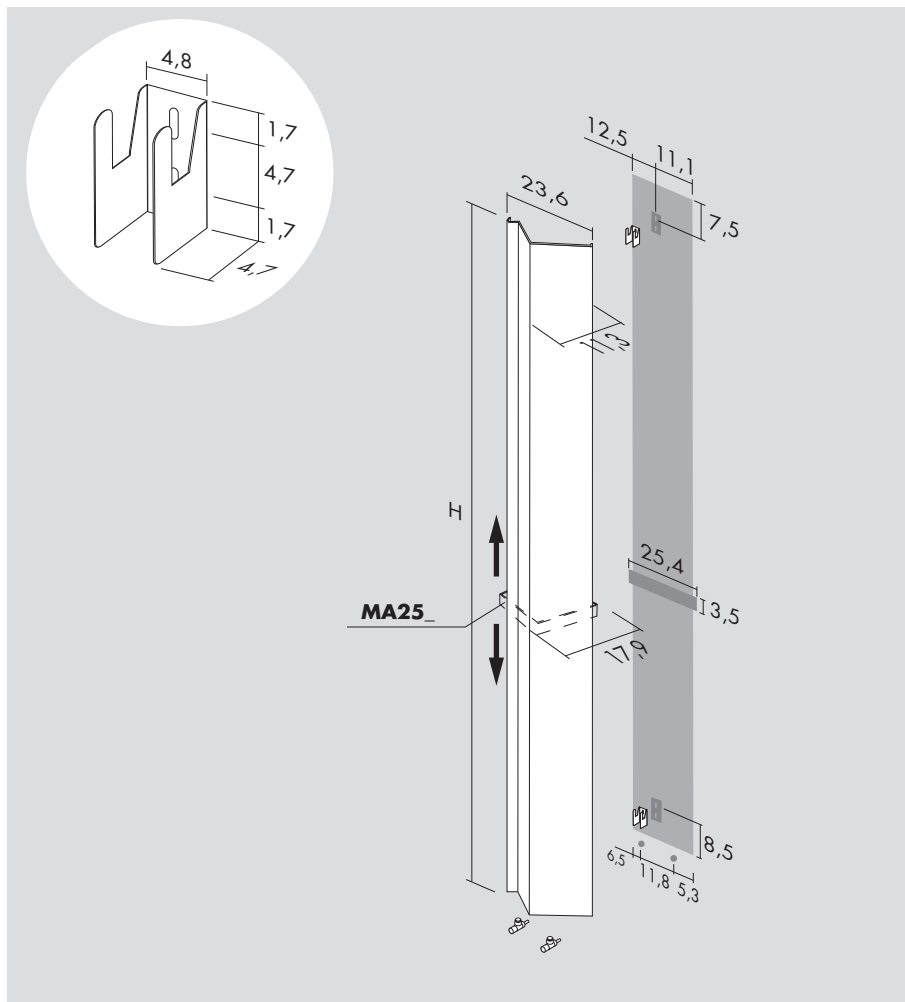

## [F]

Standard connection / Raccord standard  
Standard Anschluss / Conexión estándar

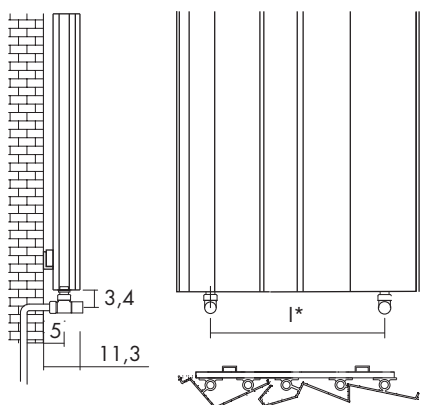

## [H]

Special connection / Raccord spéciale / Speziell Anschluss / Conexión especial

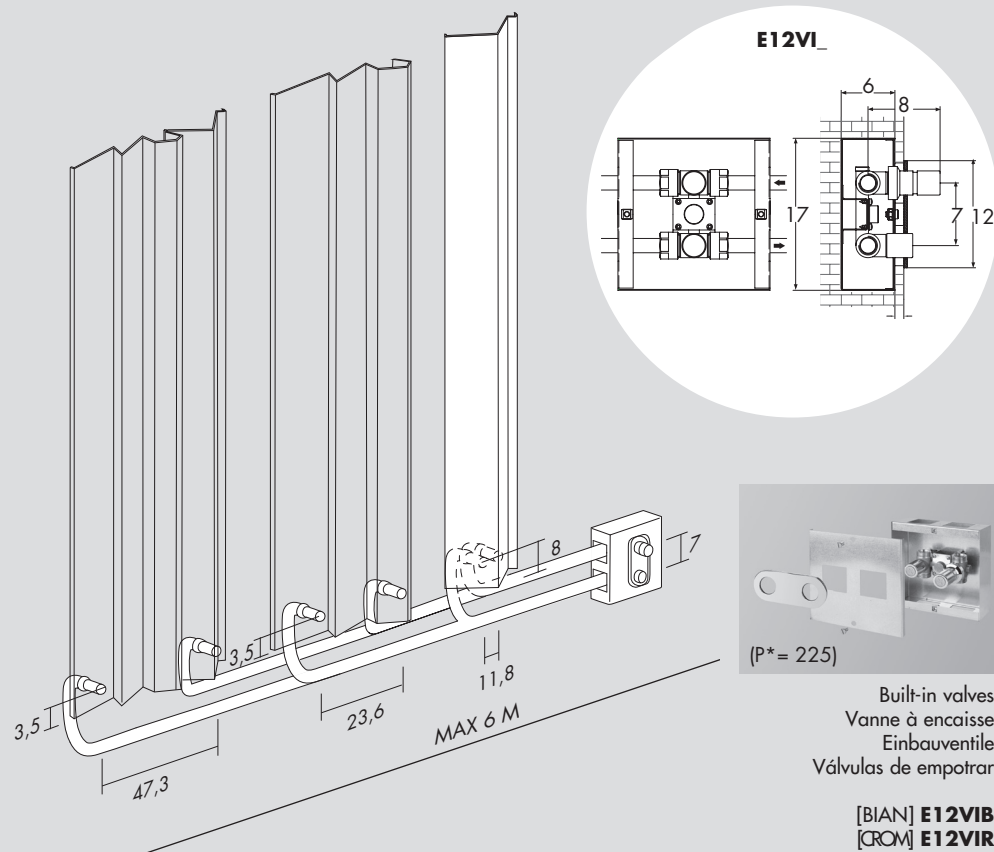

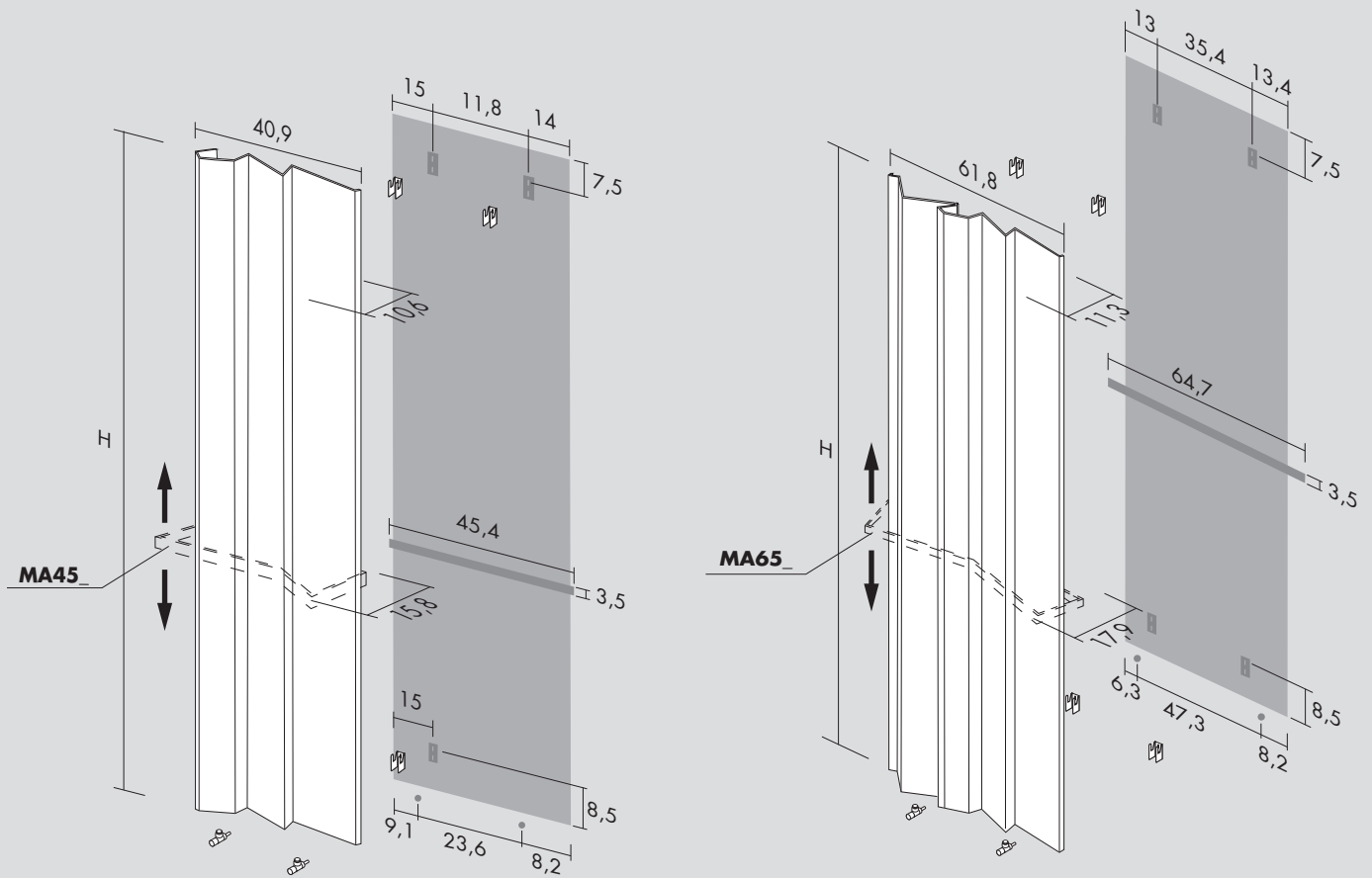

## Android V

H cm	L cm	I* cm	art*	lit*	watt $\Delta t$ 30°	watt $\Delta t$ 50°
150.0	23.6	11.8	<b>ANDV150023_</b>	0.9	240	<b>464</b>
150.0	40.9	23.6	<b>ANDV150040_</b>	1.5	384	<b>742</b>
150.0	61.8	47.3	<b>ANDV150061_</b>	2.5	596	<b>1 153</b>
180.0	23.6	11.8	<b>ANDV180023_</b>	1.0	283	<b>547</b>
180.0	40.9	23.6	<b>ANDV180040_</b>	1.8	452	<b>875</b>
180.0	61.8	47.3	<b>ANDV180061_</b>	2.9	703	<b>1 360</b>
200.0	23.6	11.8	<b>ANDV200023_</b>	1.2	312	<b>603</b>
200.0	40.9	23.6	<b>ANDV200040_</b>	1.9	498	<b>964</b>
200.0	61.8	47.3	<b>ANDV200061_</b>	3.3	775	<b>1 499</b>

## Optional



(P\* = 224)

Angled Valve  
 Robinet équerre  
 Eckausführung Ventil  
 Válvula a escuadra

[BIAN] **E125QB**  
 [CROM] **E125QR**



(P\* 226)

Thermostatic head  
 Tête thermostatique  
 Thermostatkopf  
 Cabezal termostático

[BIAN] **TTB**  
 [CROM] **TTR**

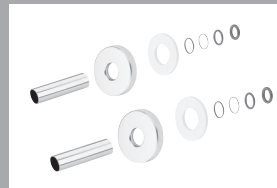

$\varnothing \leq 16$  mm  
 [BIAN] **CTB**  
 [CROM] **CTR**

16 mm <  $\varnothing$  > 24 mm  
 [BIAN] **CWB**  
 [CROM] **CWR**

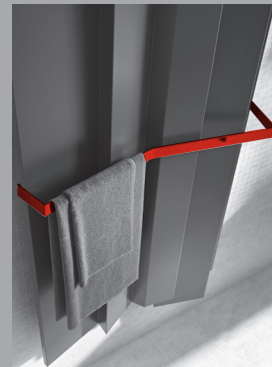

25,4 cm  
 [XLUC] **MA25L**  
 [COLOUR] **MA25C**  
 [GOLD] **MA25G**  
 45,4 cm  
 [XLUC] **MA45L**  
 [COLOUR] **MA45C**  
 [GOLD] **MA45G**  
 64,7 cm  
 [XLUC] **MA65L**  
 [COLOUR] **MA65C**  
 [GOLD] **MA65G**

art\* = item / modèle / Artikel / artículo    I\* = pipe centres / distance entre départ et retour / Achsabstand / distancia entre las conexiones  
 lit\* = water content for each element / volume d'eau pour chaque element / Wassergehalt für Element / contenido de agua por cada elemento  
 P\* = page / page / Seite / página



Kcal= Watt x 0.860  
 BTU= Watt x 3.413

Watt  $\Delta t$  60°= Watt  $\Delta t$  50° x 1.257  
 Watt  $\Delta t$  40°= Watt  $\Delta t$  50° x 0.755  
 Watt  $\Delta t$  30°= Watt  $\Delta t$  50° x 0.526  
 Watt  $\Delta t$  20°= Watt  $\Delta t$  50° x 0.316

$p_{max} = 5.0 \text{ bar}$

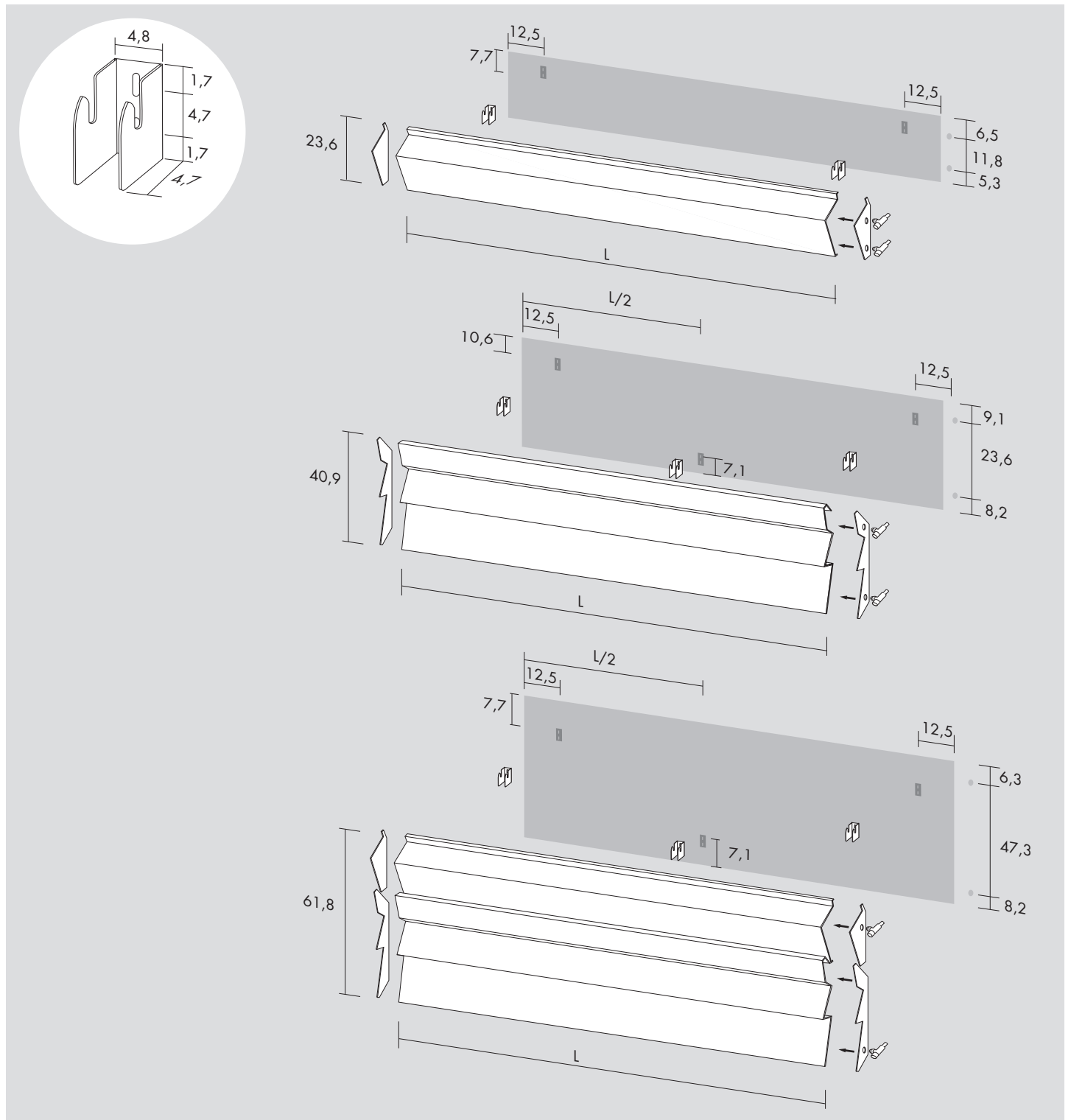

[F]

Standard connection / Raccord standard  
 Standard Anschluss / Conexión estándar

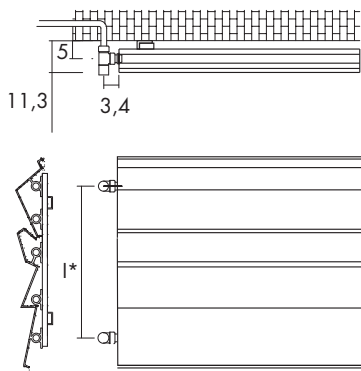

[H]

Special connection / Raccord spéciale / Speziell Anschluss / Conexión especial

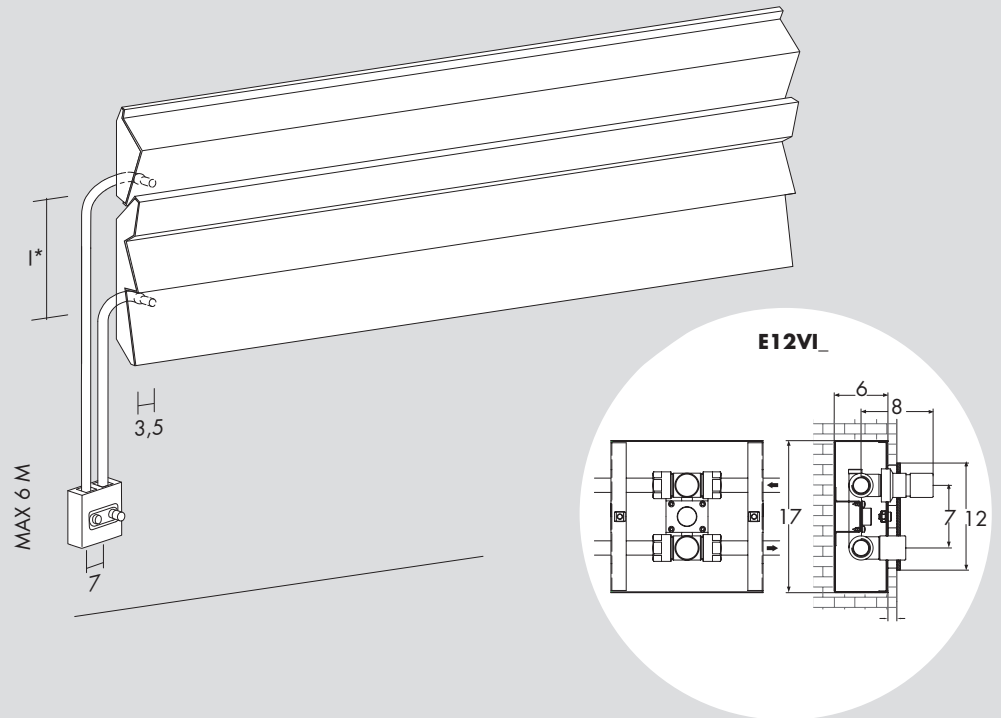

[FS]

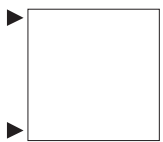

[FD]



[HS]

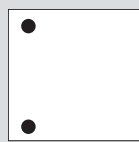

[HD]

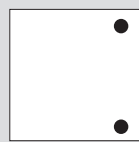

**Android O**

H cm	L cm	l* cm	art*	l <sup>*</sup>	watt $\Delta t$ 30°	watt $\Delta t$ 50°
23.6	150.0	11.8	<b>ANDO150023_</b>	0.9	224	<b>426</b>
40.9	150.0	23.6	<b>ANDO150040_</b>	1.5	359	<b>682</b>
61.8	150.0	47.3	<b>ANDO150061_</b>	2.5	544	<b>1 034</b>
23.6	180.0	11.8	<b>ANDO180023_</b>	1.1	269	<b>512</b>
40.9	180.0	23.6	<b>ANDO180040_</b>	1.8	430	<b>818</b>
61.8	180.0	47.3	<b>ANDO180061_</b>	3.0	653	<b>1 241</b>
23.6	200.0	11.8	<b>ANDO200023_</b>	1.2	299	<b>569</b>
40.9	200.0	23.6	<b>ANDO200040_</b>	1.2	478	<b>909</b>
61.8	200.0	47.3	<b>ANDO200061_</b>	3.3	725	<b>1 379</b>

**Optional**



(P\* = 224)

Angled Valve  
 Robinet équerre  
 Eckausführung Ventil  
 Válvula a escuadra

[BIAN] **E12SQB**  
 [CROM] **E12SQR**



(P\* 226)

Thermostatic head  
 Tête thermostatique  
 Thermostatkopf  
 Cabezal termostático

[BIAN] **TTB**  
 [CROM] **TTR**

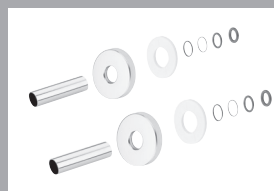

$\varnothing \leq 16$  mm  
 [BIAN] **CTB**  
 [CROM] **CTR**  
 16 mm <  $\varnothing$  > 24 mm  
 [BIAN] **CWB**  
 [CROM] **CWR**

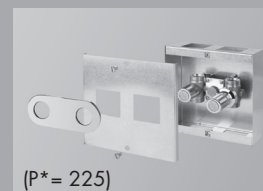

(P\* = 225)

Built-in valves  
 Vanne à encaisse  
 Einbauventile  
 Válvulas de empotrar

[BIAN] **E12VIB**  
 [CROM] **E12VIR**

art\* = item / modèle / Artikel / artículo    l\* = pipe centres / distance entre départ et retour / Achsabstand / distancia entre las conexiones  
 l<sup>\*</sup> = water content for each element / volume d'eau pour chaque element / Wassergehalt für Element / contenido de agua por cada elemento  
 P\* = page / page / Seite / página

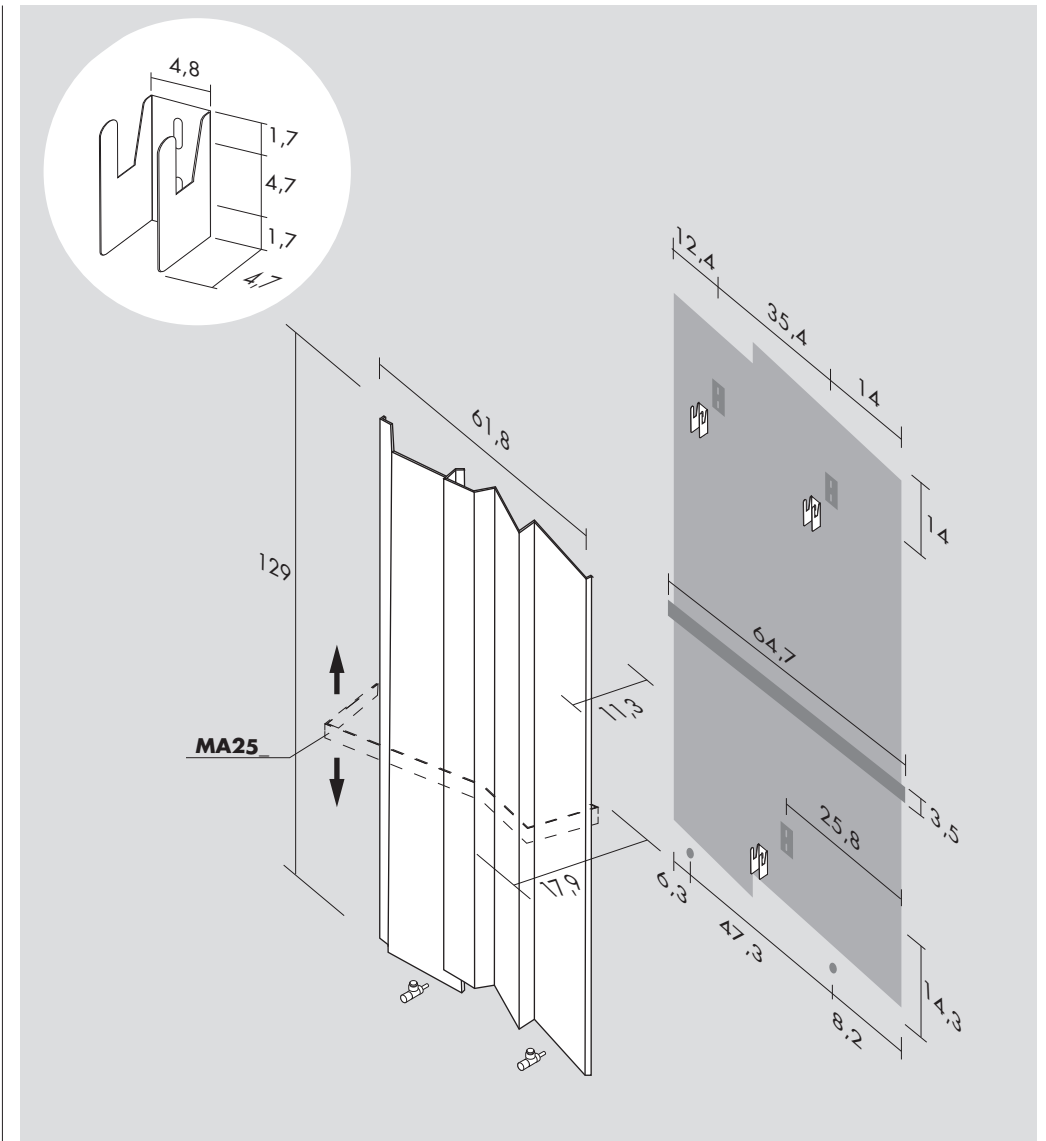

Kcal = Watt x 0.860  
 BTU = Watt x 3.413

Watt  $\Delta t$  60° = Watt  $\Delta t$  50° x 1.264  
 Watt  $\Delta t$  40° = Watt  $\Delta t$  50° x 0.750  
 Watt  $\Delta t$  30° = Watt  $\Delta t$  50° x 0.517  
 Watt  $\Delta t$  20° = Watt  $\Delta t$  50° x 0.307

p max = 5.0 bar

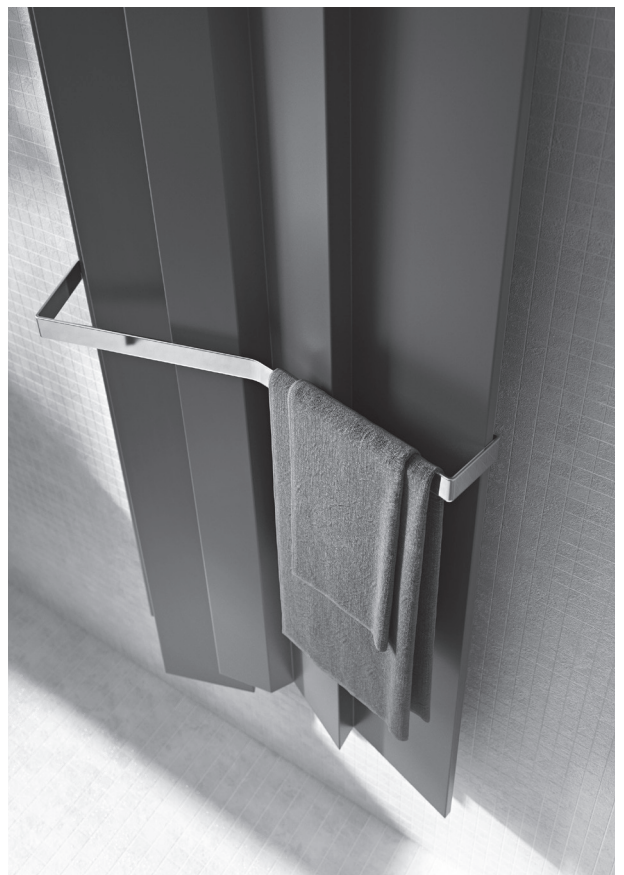

[F]

Standard connection / Raccord standard  
 Standard Anschluss / Conexión estándar

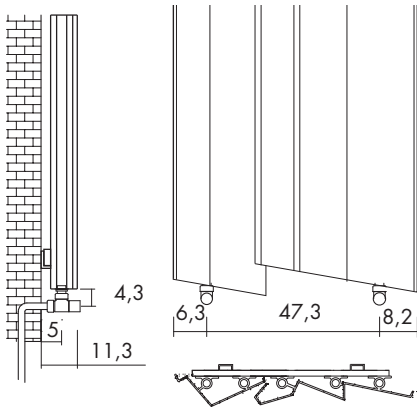

[H]

Special connection / Raccord spéciale / Speziell Anschluss / Conexión especial

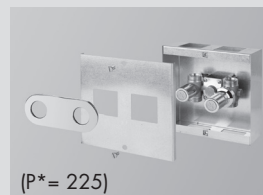
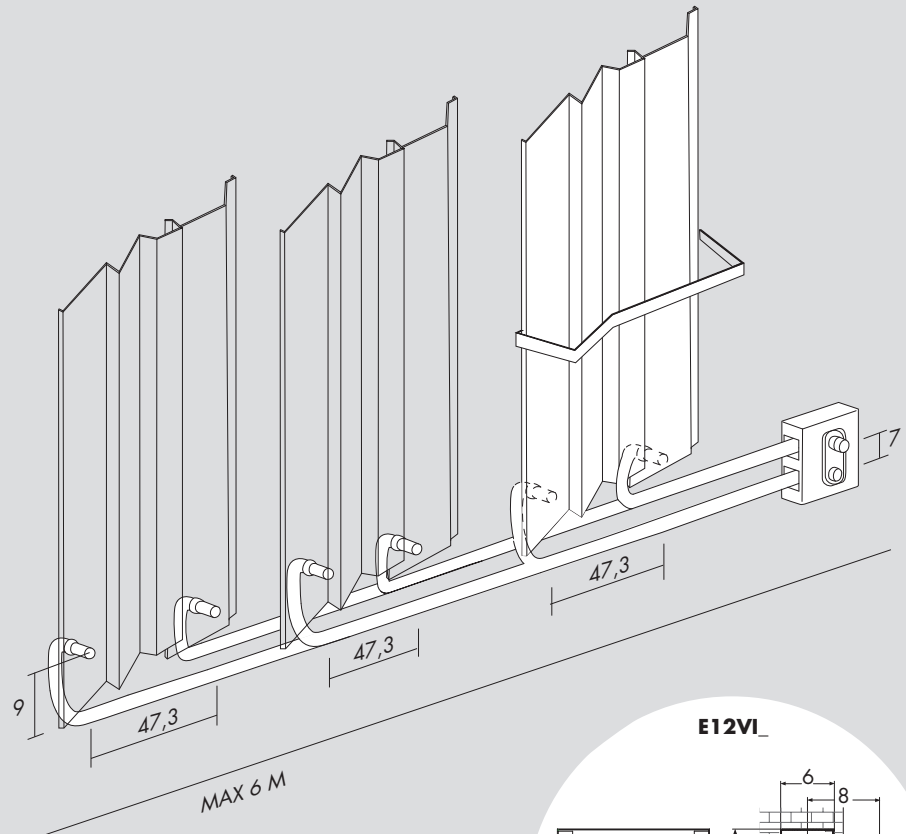

Built-in valves  
 Vanne à encaisse  
 Einbauventile  
 Válvulas de empotrar

[BIAN] **E12VIB**  
 [CROM] **E12VIR**

(P\* = 225)

**E12VI**

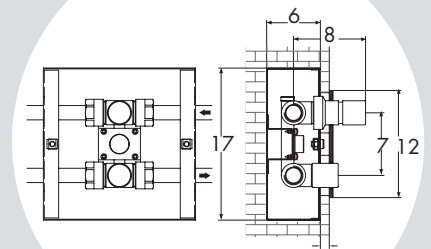

### Android IQ

H cm	L cm	I* cm	art*	Lt*	watt $\Delta t$ 30°	watt $\Delta t$ 50°
129.0	61.8	47.3	<b>ANIQ129061</b>	2.1	498	<b>964</b>

### Optional



(P\* = 224)

Angled Valve  
 Robinet équerre  
 Eckausführung Ventil  
 Válvula a escuadra

[BIAN] **E12SQB**  
 [CROM] **E12SQR**



(P\* 226)

Thermostatic head  
 Tête thermostatique  
 Thermostatkopf  
 Cabezal termostático

[BIAN] **TTB**  
 [CROM] **TTR**

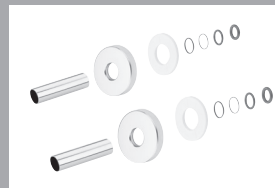

$\varnothing \leq 16$  mm  
 [BIAN] **CTB**  
 [CROM] **CTR**

16 mm <  $\varnothing$  > 24 mm  
 [BIAN] **CWB**  
 [CROM] **CWR**



Towel bar  
 Porte-serviettes  
 Hsndtuchstler  
 Porta toallas

64,7 cm  
 [XLUC] **MA65L**  
 [COLOUR] **MA65C**  
 [GOLD] **MA65G**

art\* = item / modèle / Artikel / artículo    I\* = pipe centres / distance entre depart et retour / Achsabstand / distancia entre las conexiones  
 Lt\* = water content for each element / volume d'eau pour chaque element / Wassergehalt für Element / contenido de agua por cada elemento  
 P\* = page / page / Seite / página