



FRAME FRAME PLUS

The accurate manufacturing and impeccable finishes enhance the elegance and harmony of the new Frame colours.
The colour palette is made with ecological epoxy-polyester powders with 90 gloss brightness.
The entire range is accessorized with handy and essential satin stainless steel towel racks.

- Material:**
- Horizontal collectors in painted carbon steel with \varnothing of 30 mm
 - Vertical heating elements in painted carbon steel 50x10 mm
 - Heating plate in painted carbon steel

- Fixing kit:**
- Brackets
 - Airvent
 - Hexagonal tool
 - Plugs and screws for mounting suitable for use on compact or hollow brick walls
 - User notice

Packaging:
The radiator is protected by a recyclable film in polyethylene and with a box in recyclable carton. User notice included.

Painting process:
Painted with ecological epoxy powders 90 gloss brightness. (Certificate DIN 55900-1,-2)

Accessories and spare parts:
See page 157.

P. max: 5 bar	Available for central heating systems
T. max: 95° C	Connections: n° 2 x 1/2" gas - n° 1 x 1/8" gas for Airvent

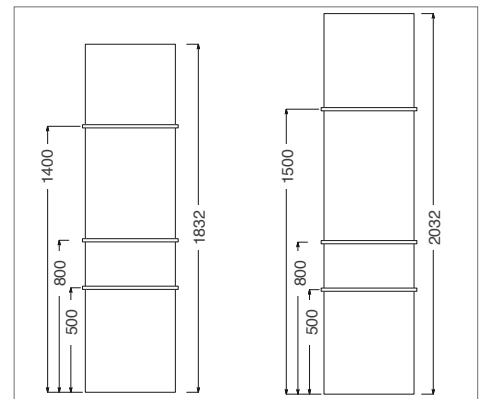
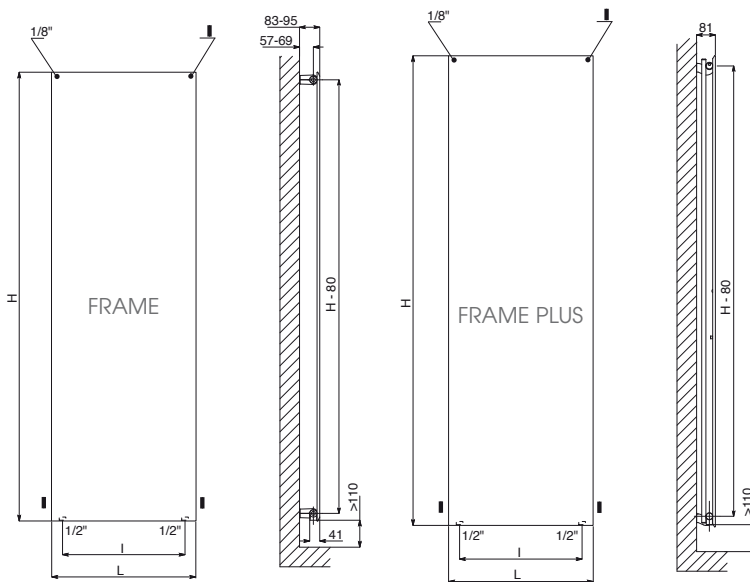

How to place kit 3 straight hangers

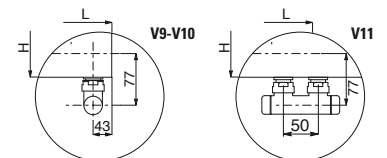

Measures for valves type "Elegant" Cordivari

STANDARD CONNECTIONS

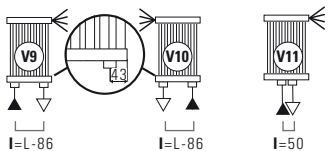

Always specify the kind of connection needed when ordering (V9 - V10 - V11).
Bidirectional connection not possible.

LEGEND	
▶ In	◀ Airvent
◁ Out	H Height
□ Connection	Width=20 - Height=15
▬ Blind Plug	
Pipe Centres	L Width

ACCESSORIES

	STRAIGHT HANGER SATIN STAINLESS STEEL (L= 516 mm) Code Nr. 5991990010208
	(L= 628 mm) Code Nr. 5991990010209

	KIT 3 STRAIGHT HANGERS SATIN STAINLESS STEEL (L= 516 mm) Code Nr. 5991990310241
	(L= 628 mm) Code Nr. 5991990310242



FRAME VERTICAL

Height	Width	FINISHING	Pipe Centres (V9 - V10)	Dry Weight	Water Content	Thermal output $\Delta t = 50^{\circ}\text{C}$		75/65/20°C ($\Delta t=50^{\circ}\text{C}$)
			I [mm]			[Kg]	[lt]	
H [mm]	L [mm]		I [mm]	[Kg]	[lt]	Watts	Kcal/h	* Thermal output ϕ in Watts and Δt in °C
1832	474	RAL 9010	388	25,1	5,6	889	765	$\phi = 5,8549 * \Delta t^{1,2840}$
	586	RAL 9010	500	31,3	7,0	1112	956	$\phi = 7,3187 * \Delta t^{1,2840}$
2032	474	RAL 9010	388	27,3	5,8	988	850	$\phi = 6,5055 * \Delta t^{1,2840}$
	586	RAL 9010	500	34,1	7,2	1235	1062	$\phi = 8,1319 * \Delta t^{1,2840}$

* For output at different Δt than 50°C, see page 162.

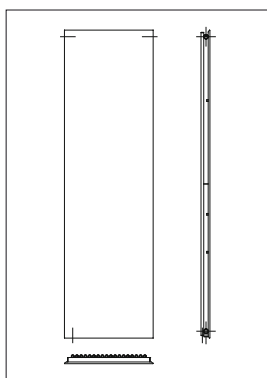

FRAME PLUS VERTICAL

Height	Width	FINISHING	Pipe Centres (V9 - V10)	Dry Weight	Water Content	Thermal output $\Delta t = 50^{\circ}\text{C}$		75/65/20°C ($\Delta t=50^{\circ}\text{C}$)
			I [mm]			[Kg]	[lt]	
H [mm]	L [mm]		I [mm]	[Kg]	[lt]	Watts	Kcal/h	* Thermal output ϕ in Watts and Δt in °C
1832	474	RAL 9010	388	35,7	11,2	1320	1135	$\phi = 9,6792 * \Delta t^{1,2840}$
	586	RAL 9010	500	45,1	13,7	1650	1419	$\phi = 12,0990 * \Delta t^{1,2840}$
2032	474	RAL 9010	388	39,5	12,3	1440	1328	$\phi = 10,4294 * \Delta t^{1,2840}$
	586	RAL 9010	500	49,9	15,0	1800	1548	$\phi = 13,0368 * \Delta t^{1,2840}$

* For output at different Δt than 50°C, see page 162.

ACCESSORIES

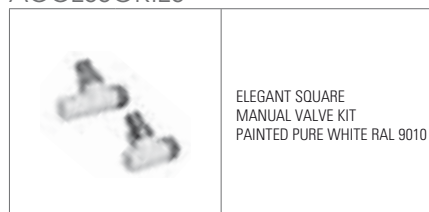

C	Code Nr.	M	Code Nr.
Ø 10/12/14/15/16	5991990311006	Ø 14/16/18	5991990311005

C = Copper connection • M = Multilayer connection

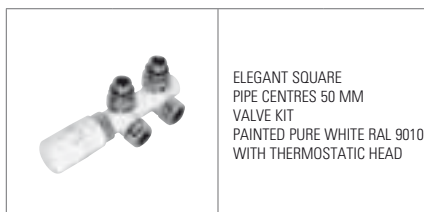

C	Code Nr.	M	Code Nr.
Ø 10/12/14/15/16	5991990311070	Ø 14/16/18	5991990311069

C = Copper connection • M = Multilayer connection



C	Code Nr.	M	Code Nr.
Ø 10/12/14/15/16	5991990311076	Ø 14/16/18	5991990311074

C = Copper connection • M = Multilayer connection

Code Nr. are referred to colour WHITE R01 - RAL 9010 version.

Accessories and spare parts - see page 157.