

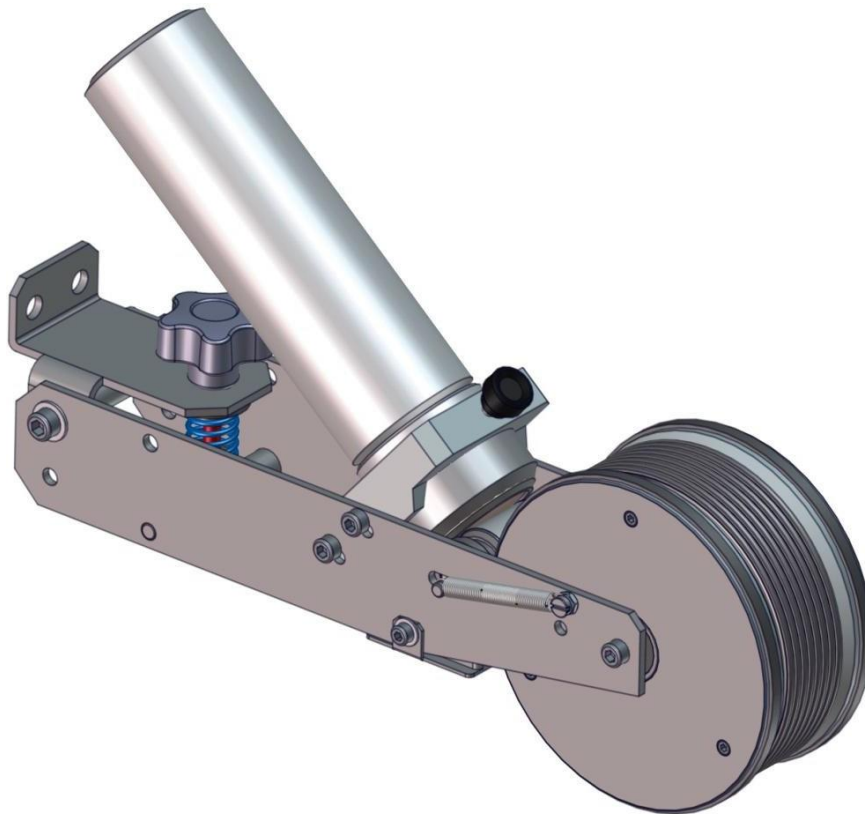

ROLLERPRINT 240-375

Instruction Manual



September 2018

Table of contents

Presentation

Introduction and Safety	1
Description	1
Signboard	1
Functions	2
Limits and exclusions.....	3
Allowed uses.....	3
Exclusions.....	3
Technical Features	4
Inking	4
Principle	4
Choice of inks	4

Shipping and installation

Shipping and handling

Shipping and handling	5
Packaging	5
Shipping conditions.....	5
Storage	5
Delivery and installation.....	6
Unpacking.....	6
Volume.....	6
Installation.....	7

Uses

Characters	8
Recommendations	8
Mounting	8
Removal.....	8
Inking	8
Inking the characters.....	8
Choice of ink	8
Adjusting ink pressure	9

Inking pressure	9
Pressure Drum / Printing material	10
Printing	10

Maintenance and recycling

Servicing and

Servicing and maintenance	11
--	-----------

General servicing and cleaning	11
---	-----------

Cleaning.....	11
---------------	----

Cleaning Kit	12
--------------------	----

Changing the Ink cartridge	12
---	-----------

Depressurization	14
------------------------	----

Changing inking foams	15
-----------------------------	----

Removing the type drum	16
------------------------------	----

Mounting the type drum	16
------------------------------	----

Periodicity of cleaning and maintenance.....	17
---	-----------

After use	17
-----------------	----

Daily	17
-------------	----

Before each ink change	17
------------------------------	----

Monthly or in case of production break of over 1 week	17
---	----

Spare parts	18
--------------------------	-----------

General break-up	19
-------------------------------	-----------

Troubleshooting	20
------------------------------	-----------

Additional products	20
----------------------------------	-----------

Cleaning agents	20
-----------------------	----

Hygiene products	20
------------------------	----

Recycling	21
------------------------	-----------

Packaging	21
-----------------	----

Shipping	21
----------------	----

Recycling	21
-----------------	----

Terms of Warranty	21
--------------------------------	-----------

Valued clients

Thank you for having chosen this Foscott Coding equipment. This user manual contains all the necessary advice and recommendations that will ensure high quality results. Please follow these recommendations carefully to obtain maximum satisfaction when using our equipment.

Presentation

Introduction and Safety

This user manual contains all the necessary information for the assembly, start up, use, maintenance and handling of the equipment.

The user manual must be readily available and stored near the corresponding equipment.

The equipment has been fitted with safety and protective devices in accordance with the present safety standards. Use of the equipment for any non-standard purpose is liable to be a safety risk or cause material damage.

The equipment must therefore be used strictly in accordance with the instructions and recommendations contained in the present manual.

Functions

The ROLLERPRINT is a flexographic printer which uses inks that can be used for continuous printing on absorbent (paper, cardboard wood...) and non-absorbent (metal, plastic...) material. The printing quality remains constant for speeds varying from 1 to up to 40 meters a minute.

The equipment includes

- A type drum with a rubber roller belt for the Baselock characters • An Anilox transfer drum
- A fixing bracket

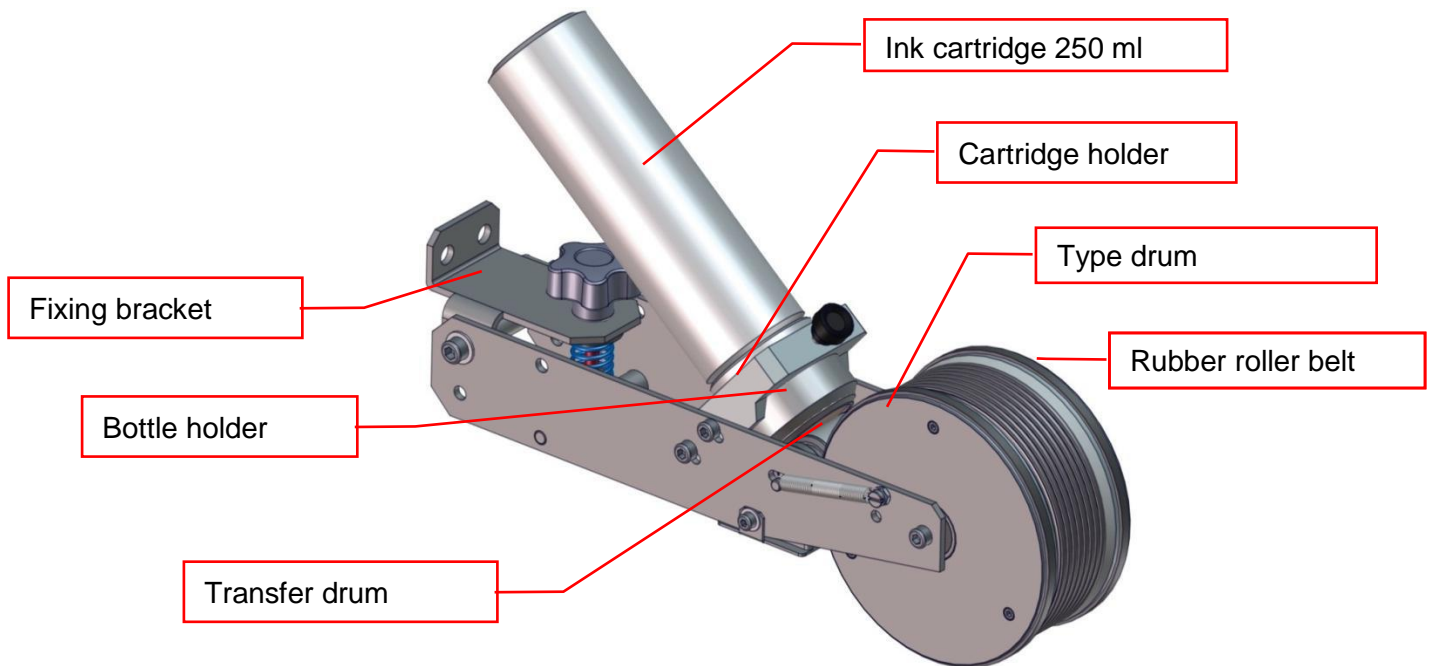

The type drum is driven by the contact between the roller belts made of rubber and the printing material. To optimize print quality, the drum is held under constant pressure through a spring.

The characters are easily interchangeable with the Baselock system (see chapter Characters).

Limits and exclusions

Any usage other than those mentioned in the present manual is not recommended.

Allowed uses

This apparatus must be used

- As a fixed work station
- By trained and skilled operators who have read the present document before using the machine
- Indoors, in a climate controlled area
- In an area with sufficient lighting - minimum 350 lux.
- In a dust and debris free zone
- Maintained and cleaned according to the instructions in the manual

Exclusions

- Do not use in humid zones
- Not to be used by more than one operator simultaneously
- Do not use cleaning agents, or other products not recommended by Foscott

Technical Features

	ROLLERPRINT 240	ROLLERPRINT 375
DRUM FEATURES		
Type drum height	25 mm	
Number of grooves on drum	8	
Diameter	76,4 mm	119,85 mm
Maximum size	240 mm	375 mm
Maximum character length	222 mm	350 mm
Maximum character height	24 mm	
Volume		
Length	282 mm	329 mm
Width	79,9 mm	
Height	189 mm	211 mm
Weight	1,66 kg	1,8 kg
MECHANICAL FEATURES		
Marking speed	1 to 40 m/min	
Drive	By contact with printing material	

Inking

Principle

An easy-mount liquid ink cartridge supplies the ROLLERPRINT.

The ink is quick-drying.

A number of different quality inks have been developed for varied applications and printing material.



- Before use, please read the Safety instructions for the products used.
- Always wear safety equipment as recommended in the Safety documentation (gloves, etc.)

Choice of inks

See the Table of inks with the features and detailed descriptions of our inks. These documents are found in our General catalogue. If necessary, please contact the Foscott Packaging Customer Service.

Shipping and handling

Shipping and handling

Packaging

The equipment is packed in a cardboard box with pre-cut foam inserts.
Keep the packaging safely.

The machine must be repacked in the original packaging for any further transport.

Shipping conditions

The material must be transported upright in its packaging on a dry, stable and non-slippery surface.

Storage

The material must be stored in a dry climate controlled area.

Delivery and installation

Unpacking

- Unpack carefully so as not to damage the machine during unpacking
- Keep the packaging intact to permit re-use in case of further transport
- Check for the following items:
 - 1 ROLLERPRINT,
 - 1 user manual CD-ROM,
 - 1 EEC Standards certificate

Volume

ROLLERPRINT 240

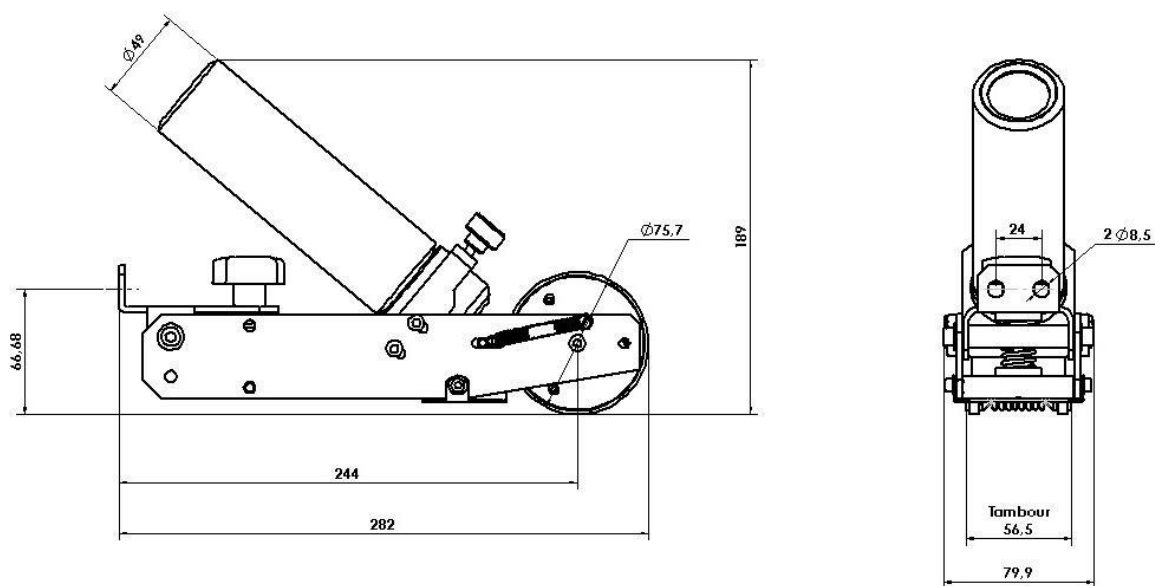

ROLLERPRINT 375

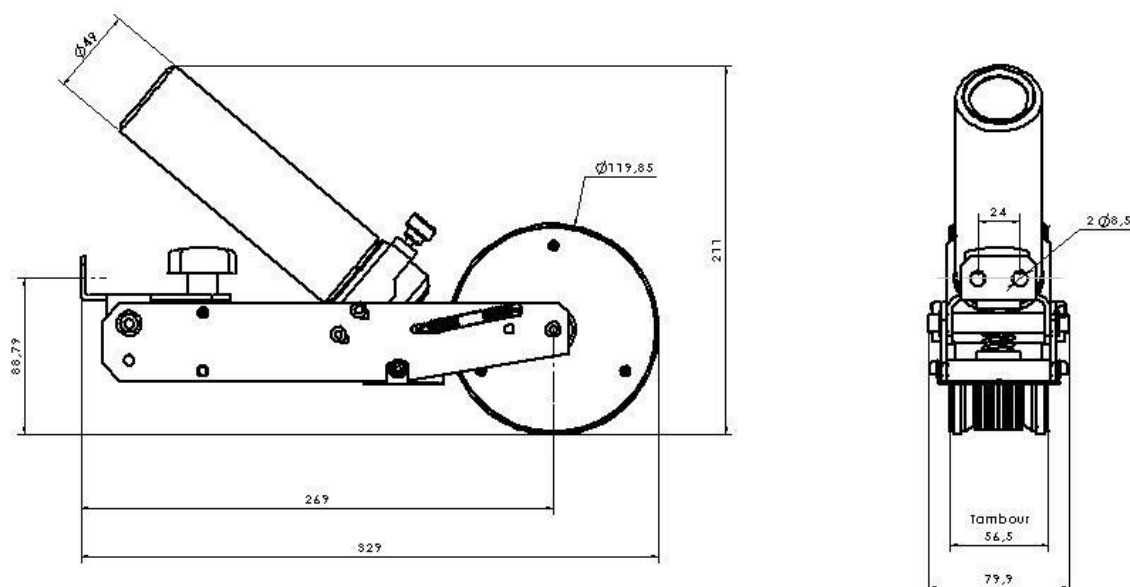

Installation

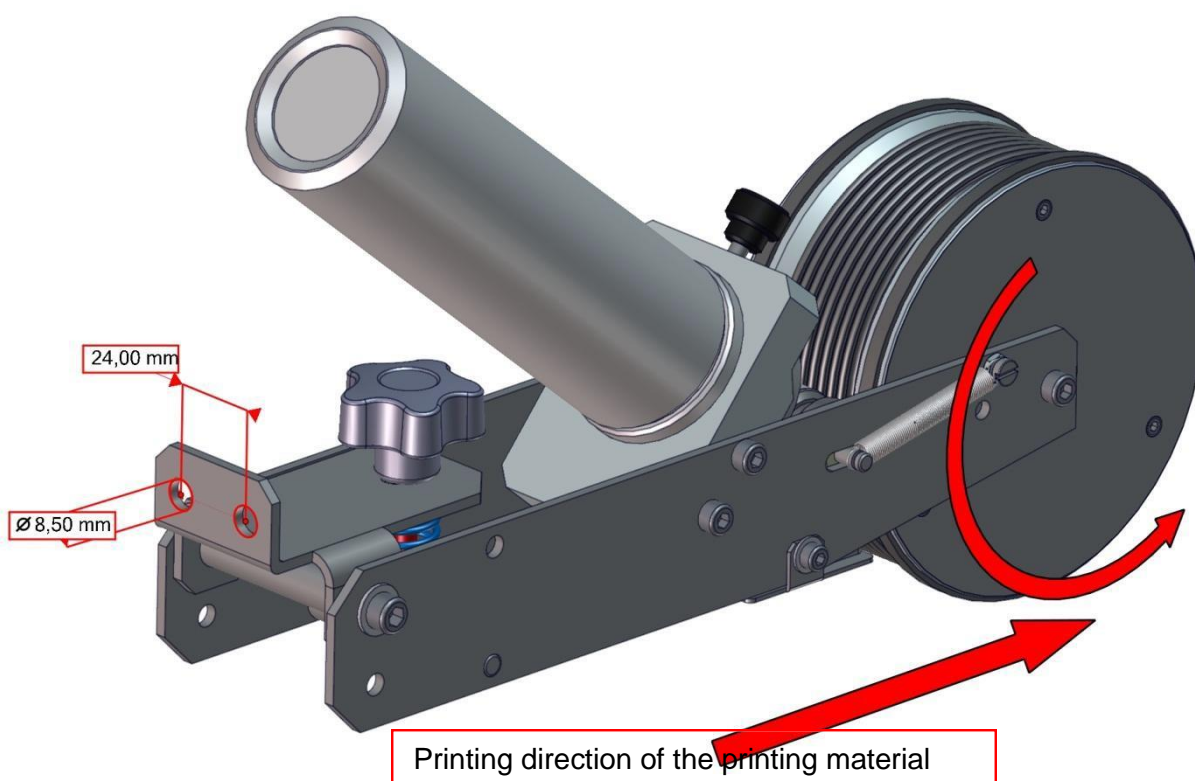

- Set up the ROLLERPRINT equipment for a print run from the back (bracket side) to the front (drum side)
- Put the equipment in a horizontal position, parallel to and above the printing material.
- Adjust the equipment so that the 2 roller belts touch the printing material
- Fix the equipment with the M8 screws, using the two 8.5mm diameter holes of the frame.



Please follow the instructions carefully to avoid poor quality prints.

Settings

- Set inking pressure (see chapter Inking pressure)
- Set printing pressure (see chapter Drum / printing material pressure)

General checks

- Check that the equipment is properly fixed and held in place, and that the type drum is touching the printing material.

Uses

Characters

Recommendations

- Use the Baselock System
- Contact the Foscott Packaging Customer Service to learn about other possible clips on specific type drums

Mounting

- Put the characters on the type drum,
- Press the characters against the drum to clip it on.

Removal

- Pull off the characters perpendicularly from one end to remove.

Inking

Ink to the ROLLERPRINT is supplied by an easy-mounting ink cartridge.

To change ink types, change the ink cartridge



- All the elements of the equipment must be cleaned (see chapter General servicing and maintenance) at each ink change (color, quality, ...)
- Please read the Safety instructions of any product before use
- the recommended safety equipment (gloves...)

Inking the characters

The characters are inked through contact with the Anilox transfer drum.

Choice of ink

Please consult the Table indicating the features and detailed description of our different inks. This Table is found in or General catalogue.

Adjusting ink pressure

Carefully adjusting ink pressure is essential for obtaining high quality prints

Inking pressure

This setting ensures the right amount of ink as well as the contact pressure between the ink cartridge set, the Anilox transfer drum and the characters.

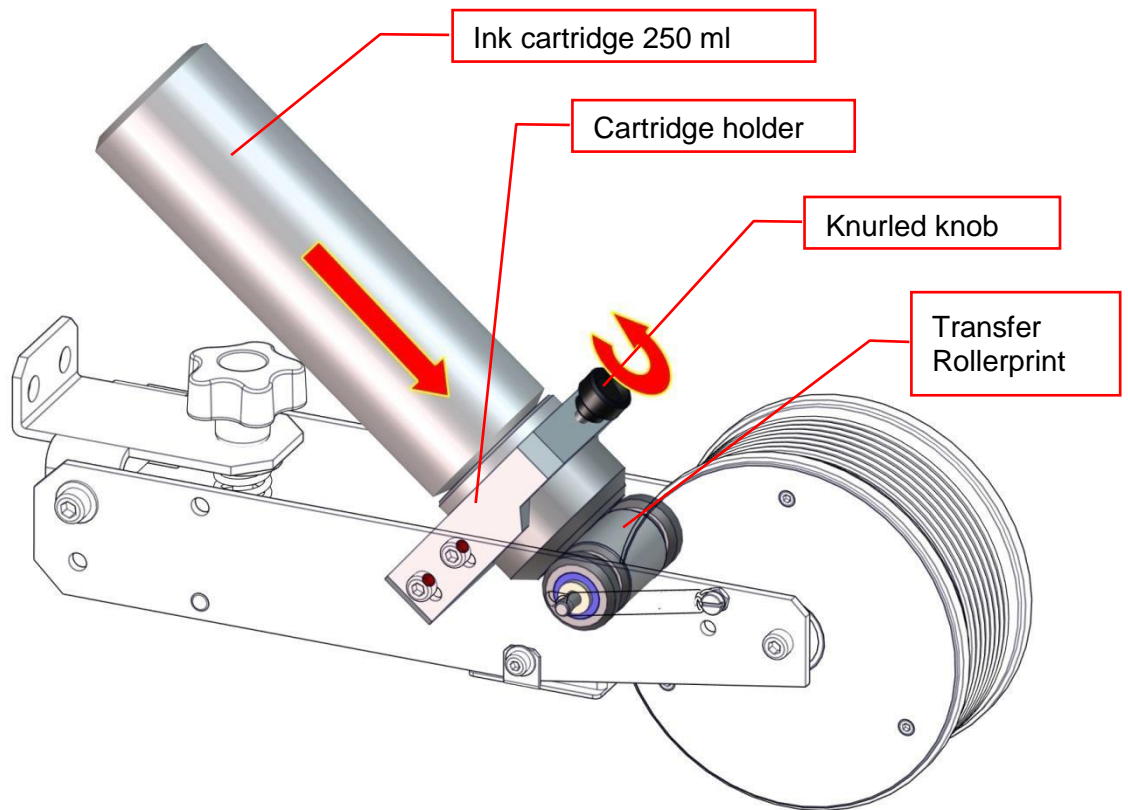

- Unscrew the knurled knob.
- Adjust contact pressure between the inking set, the Anilox and the characters by lowering the inking set. Pressure exerted by the pull of gravity (full ink cartridge) is generally sufficient.
- Tighten the knurled knob
- Check that the inking foam and Anilox are in contact, that the Anilox and the characters are touching and that the knurled knob is properly fastened.

Pressure Drum / Printing material

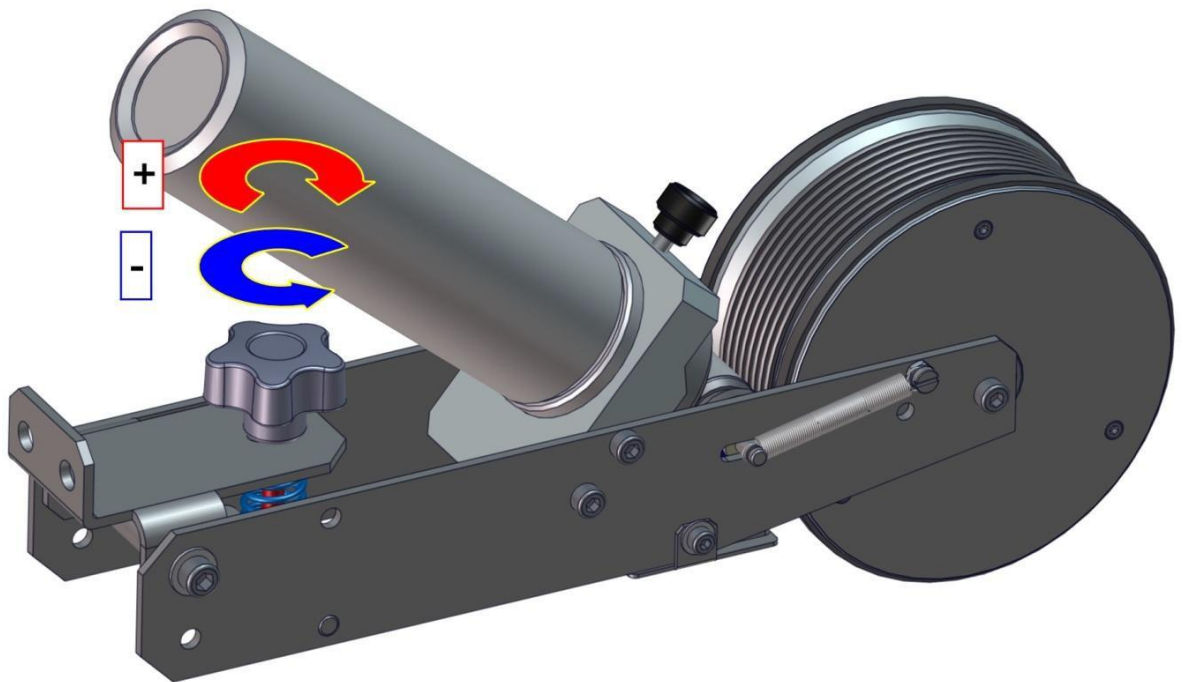

- Increase printing pressure by turning the knob clockwise, and decrease pressure by turning anti-clockwise

Printing

- Put in an ink cartridge
- Adjust inking pressure
- Adjust drum / printing material pressure

Maintenance and Recycling

Servicing and maintenance

For any servicing, maintenance, troubleshooting, order or question, please call the Customer Service.

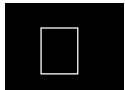

Always switch of the power supply before any intervention.

General servicing and cleaning

Cleaning

Use the CP009 Cleaning Kit to clean your machine

Use AERONET or NETTOL for servicing and maintenance :

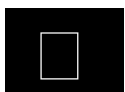
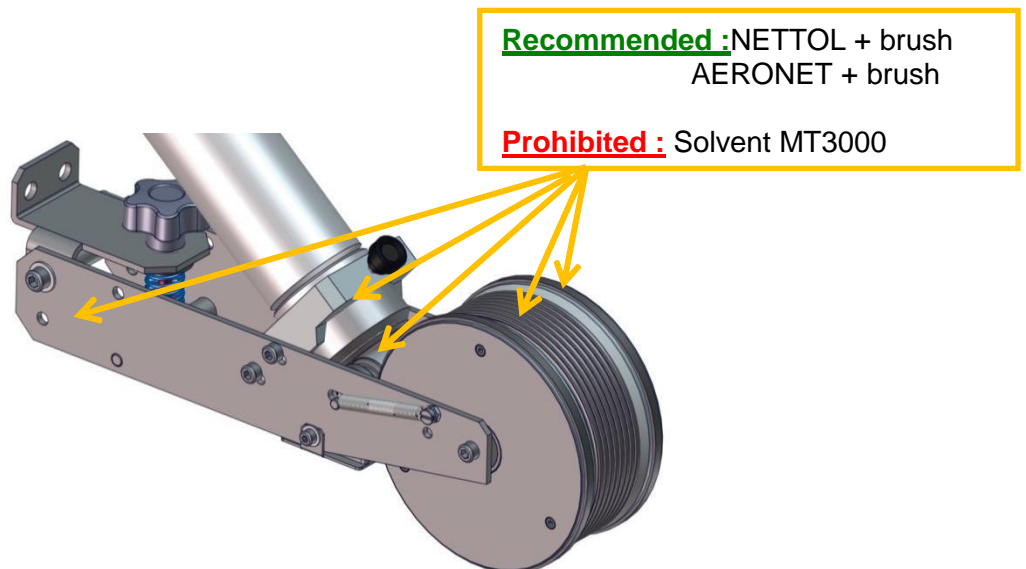

- Please read the Safety instructions of any product before use.
- Use the recommended safety equipment (gloves, ...)



- The characters or the type drum must never be dipped in a solvent or any other product.

Cleaning Kit

The kit includes a sprayer and two different nylon brushes.

Changing the Ink cartridge

- Unscrew the knurled knob to remove the ink cartridge

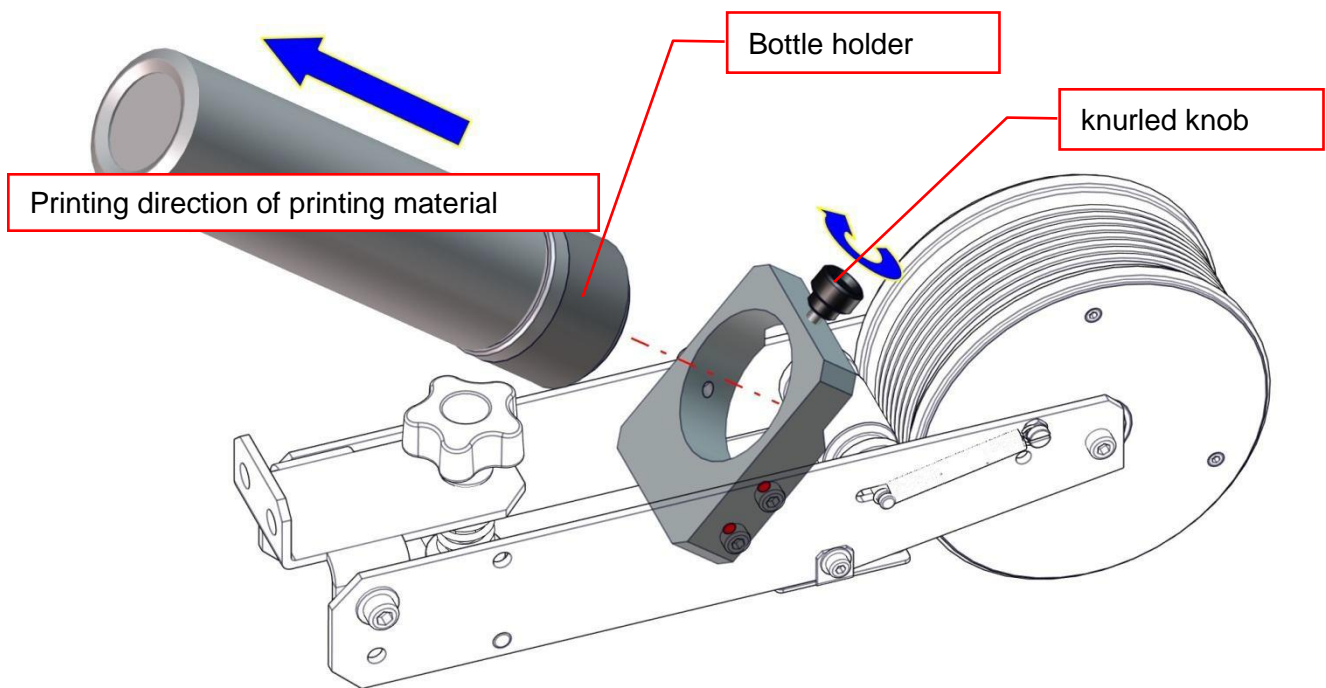

- Remove bottle holder from the old cartridge and put it on the new one

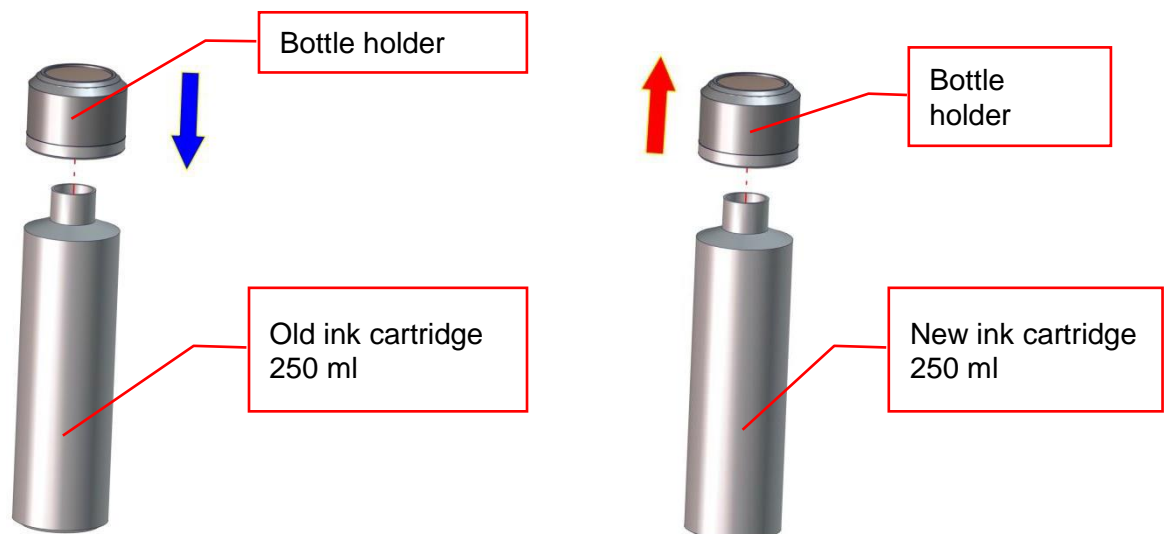

Replace the new ink cartridge on the machine and fasten it in place with the knurled knob.

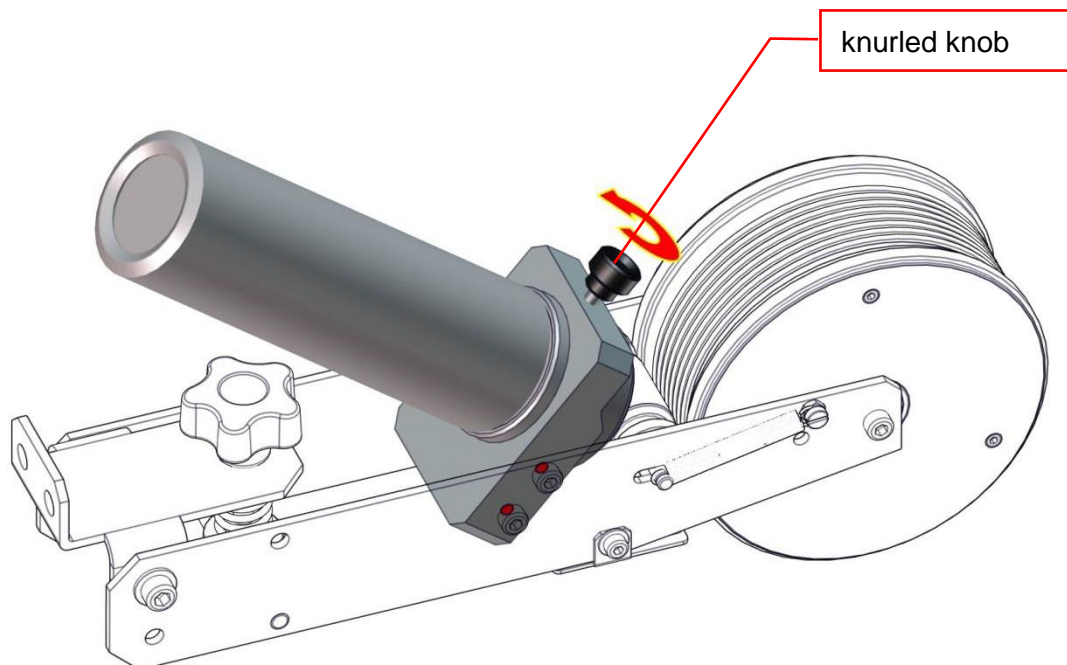
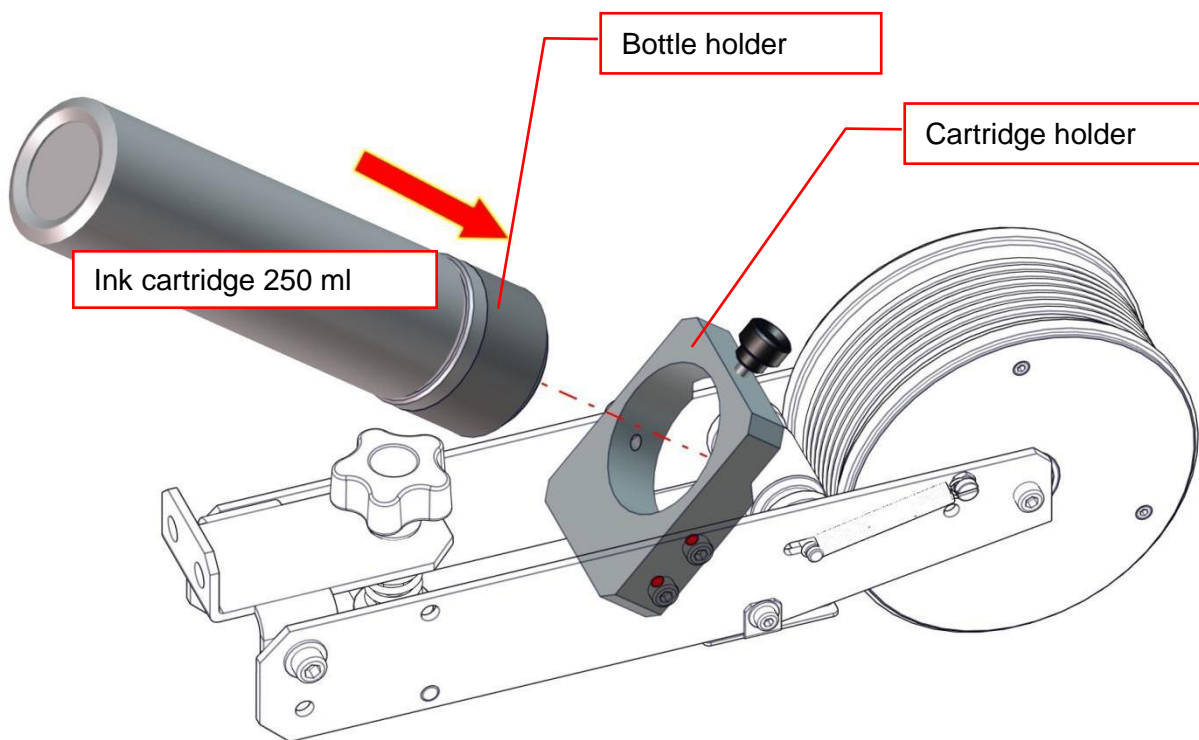

- Adjust inking pressure (see chapter Adjusting ink pressure)

Depressurization

After ink cartridge change or inking foam change, or if there is a lack of ink, the ink cartridge must be depressurized.

- Unscrew the knurled knob
- Remove inking set and bottle holder
- Hold the inking set and the bottle holder with the foams pointing upwards.
- Gently press on the cartridge till bubbles appear on the surface of the inking foam.
- Gently release pressure turning the inking set and bottle holder upside down.
- Replace the inking set and bottle holder on the machine.
- Tighten the knurled knob.

Changing inking foams

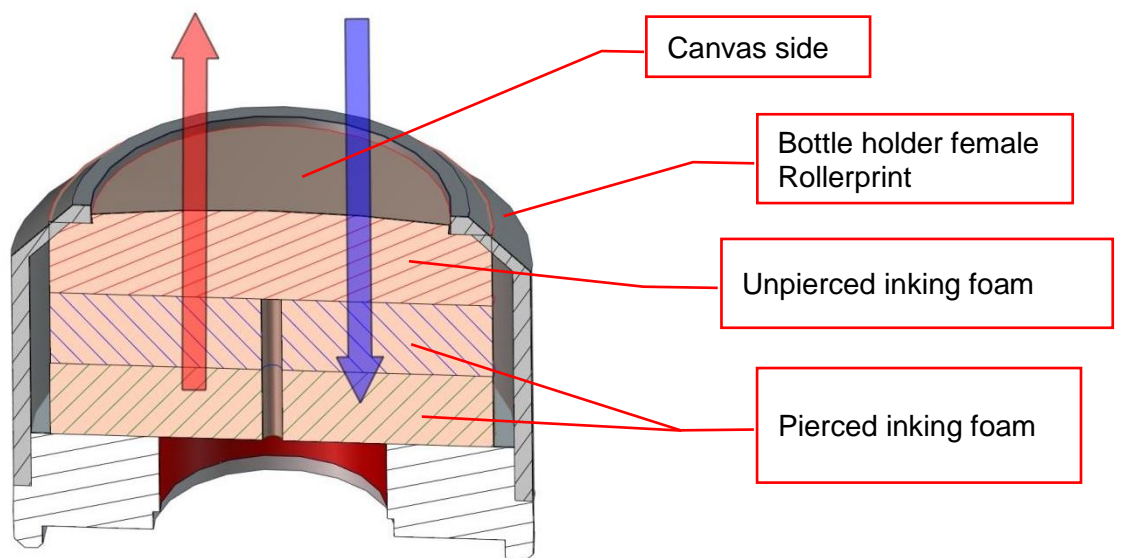
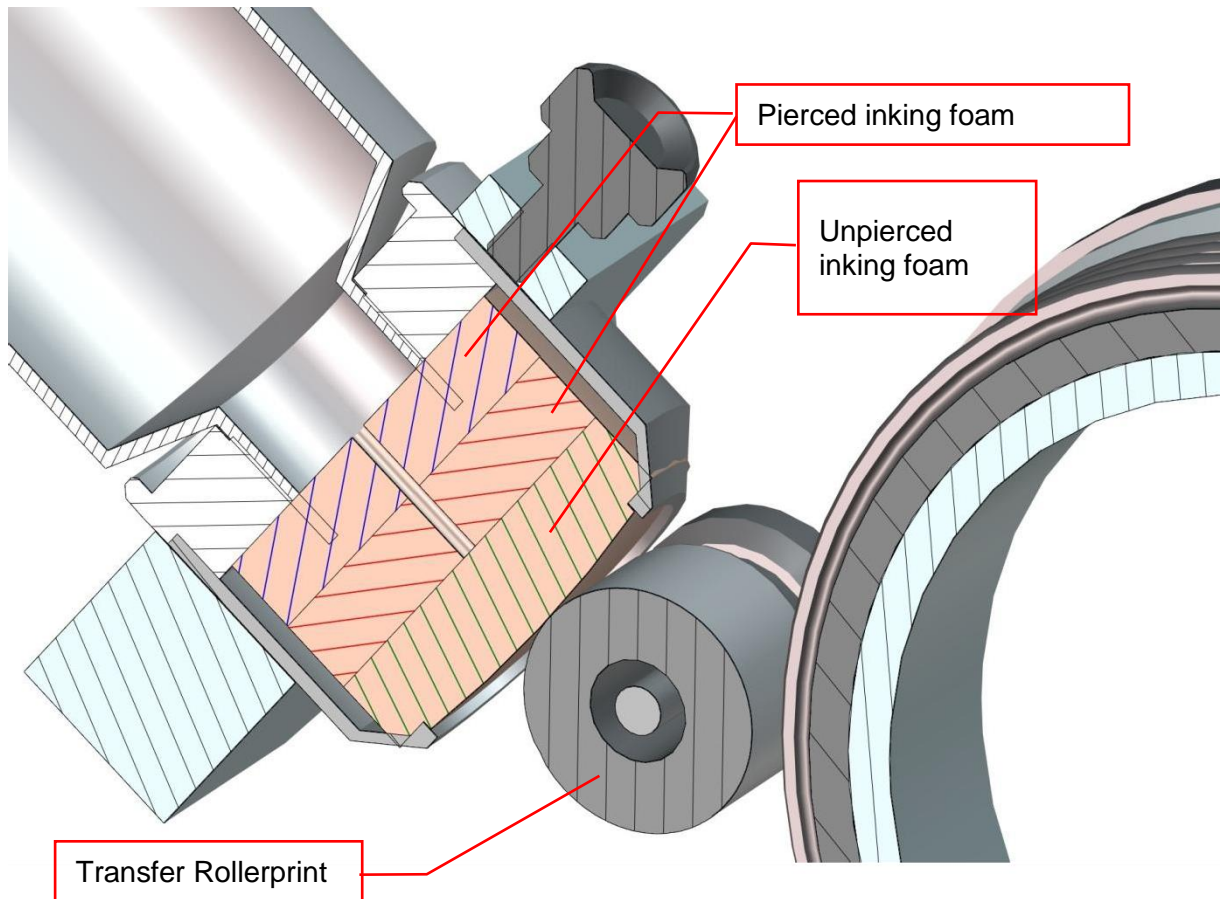

- Remove inking set and bottle holder
- Remove ink cartridge
- Remove the three inking foams by pulling them out from the widest aperture
- Clean the bottle holder (see chapter Cleaning)

- Insert 2 pierced inking foams through the widest aperture.
- Insert 1 unpierced inking foam through the widest aperture keeping the canvas side to the exterior (Anilox side).



- Change all 3 foams at the same time.
- Change all 3 foams at each ink change (type, quality color...)
- Depressurize the ink cartridge at each ink cartridge or ink foam change.

Removing the type drum

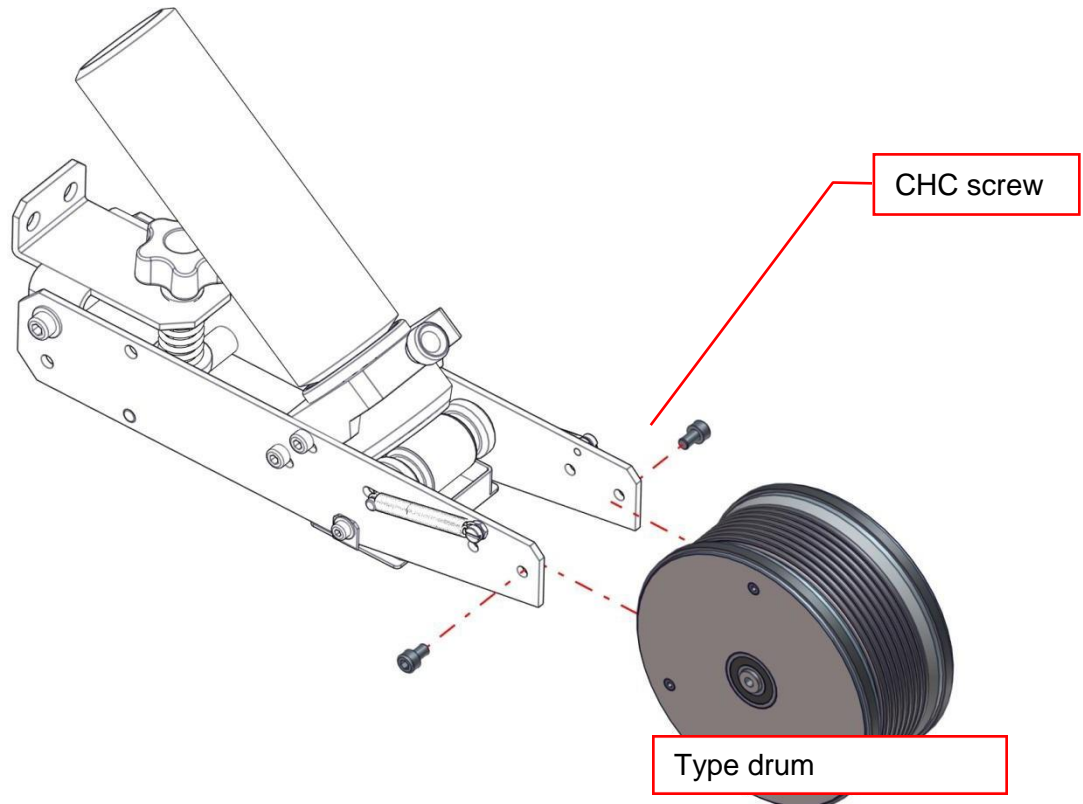

- Unscrew the CHC of the drum with a size 5 hex key
- Remove the type drum.

Mounting the type drum

- Insert the CHC screw in the holder.
- Fit in the drum.
- Fasten the drum in place with a size 5 hex key.
- Check that the drum and screw are properly fastened.

Periodicity of cleaning and maintenance

After use

Clean:

- The characters.

Daily

Clean:

- Type drum and roller belts,
- Characters.

Before each ink change

Clean:

- Type drum and roller belts,
- Character,
- bottle holder,
- Anilox drum.

Replace:

- Inking foams

Monthly or in case of production break of over 1 week

Clean and service:

- Type drum and roller belts
- characters

Remove, clean and service

- the support frame
- cartridge holder
- bottle holder

Replace

- Inking foams

Spare parts

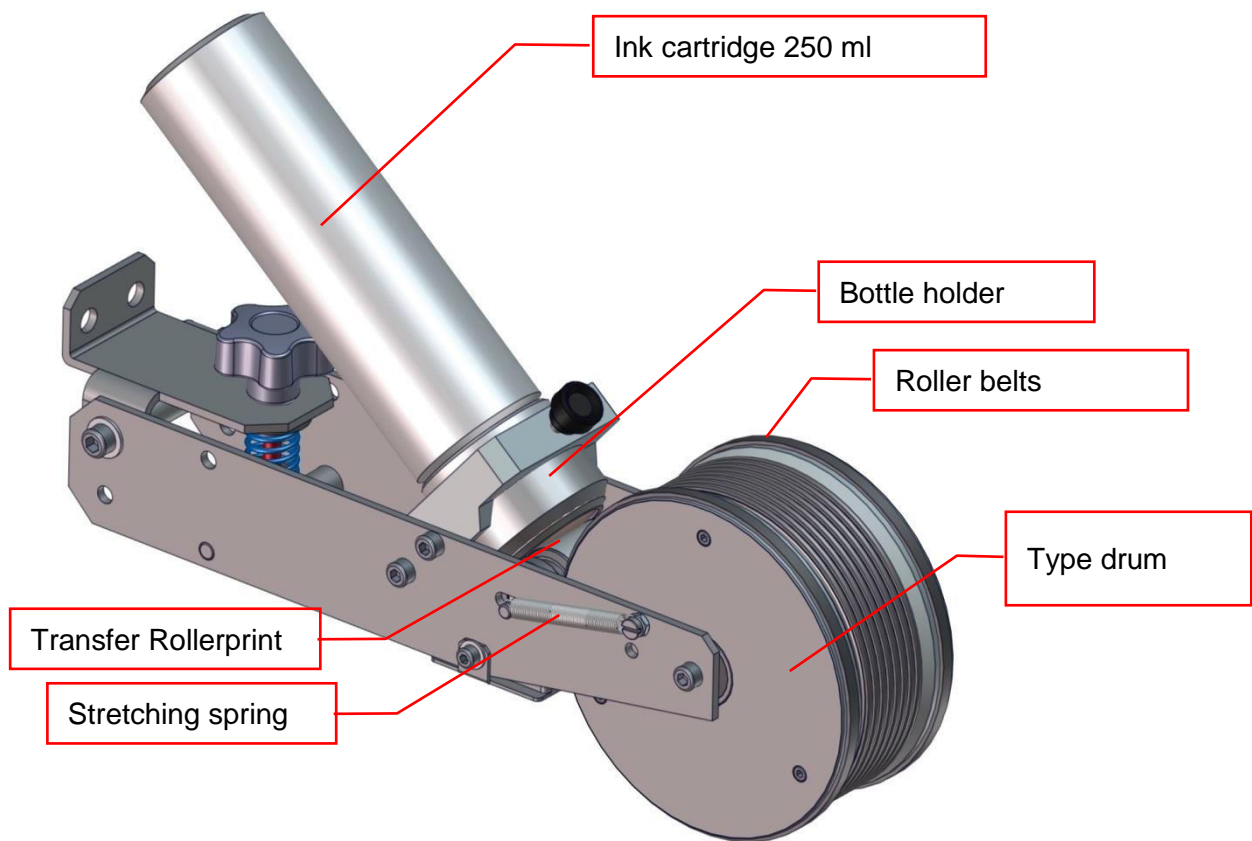

PARTS	ROLLERPRINT 240	ROLLERPRINT 375
Type drum	08A240SE4	08A375SE4
Roller belts	0815001021	087P006
Anilox drum	08ACSE3	
Bottle holder	08ACSE6	
Extension spring	08B0310236	
Cleaning brush (nylon)	08BP004	
Cleaning kit	08BP005	

General break-up

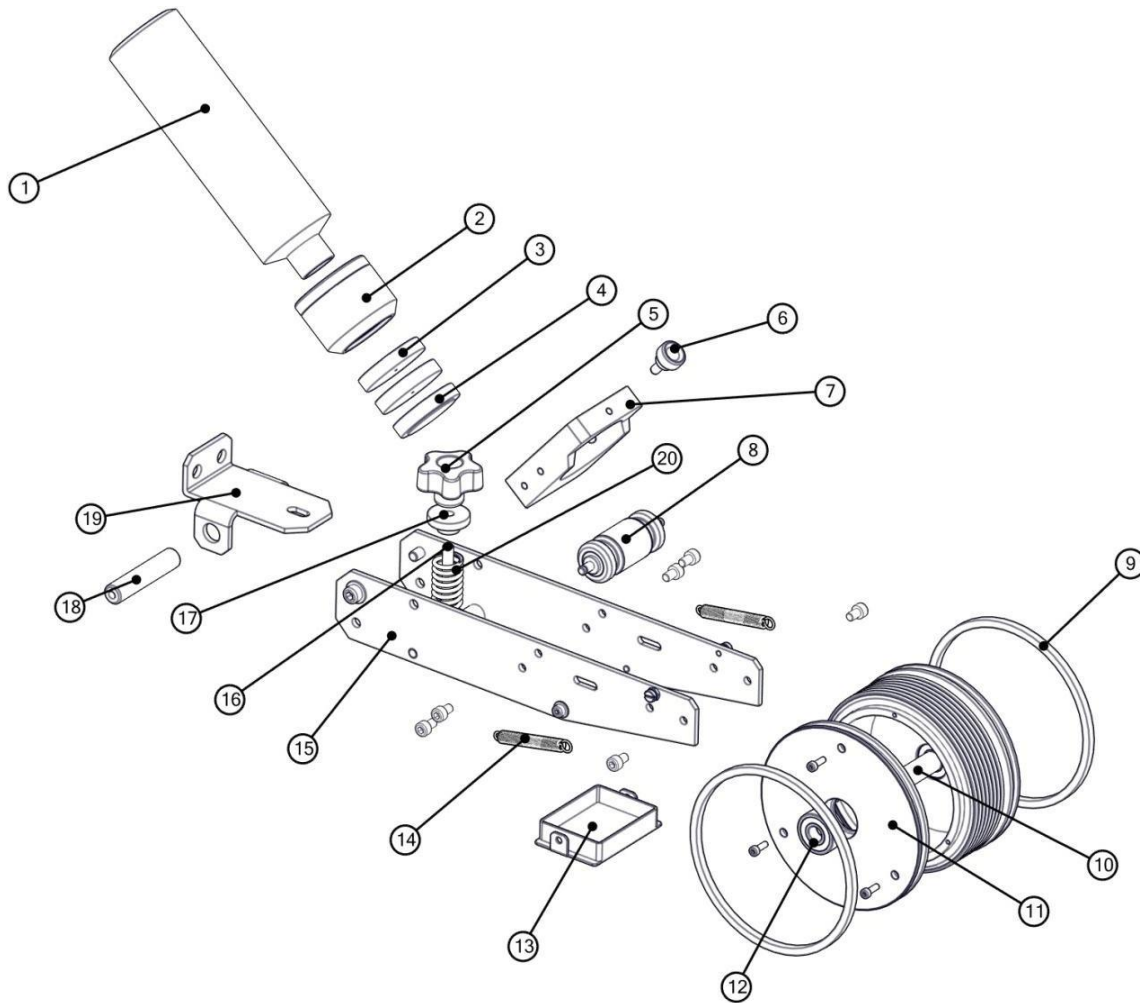

Number	Name
1	Ink bottle250 ml
2	Bottle holder set
3	Pierced inking foam
4	Unpierced inking foam
5	Knob
6	Knurled knob
7	Cartridge holder
8	Transfer drum
9	Roller belts
10	Drum shaft
11	Shaft cover
12	Ball bearing 6000
13	Ink overflow
14	Stretching spring
15	Support frame
16	Spindle
17	Spring cap
18	Bracket pin
19	Bracket
20	Compression springs

Troubleshooting

DEFECT	INDICATION	ACTION
No printing	Lack of Ink	<ul style="list-style-type: none"> ○ Change ink cartridge ○ Check that the inking foam / Anilox / characters are properly touching and adjust pressure. ○ Depressurize the ink cartridge.
	The drum is not touching the printing material	<ul style="list-style-type: none"> ○ Adjust drum / printing material pressure
	The drum and the printing material are not parallel	<ul style="list-style-type: none"> ○ Adjust the set-up of the printing material.
Poor quality printing	Ink is not evenly spread on the characters	<ul style="list-style-type: none"> ○ Change ink cartridge ○ Adjust inking pressure ○ Depressurize the ink cartridge ○ Clean the characters
	The printing material slips or slides off the drum	<ul style="list-style-type: none"> ○ Adjust the drum / printing material pressure ○ Clean roller belts ○ Change roller belts
Impossible or difficult to mount characters	Fitting characters on drum is difficult (especially large formats)	<ul style="list-style-type: none"> ○ Spray AERONET on the grooves of the drum and characters

Additional products

Cleaning agents

NETTOL

Thinner in 5l cans. Check that the thinner is compatible with the type of ink used.

AERONET

Spray thinner, specifically recommended for cleaning the characters.

Absorbent cotton wadding

Roll of 800m. Pre-cut to 40 by 30cms for easy cleaning.

Hygiene products

Protective cream

240ml spray can. Protects hands and arms from inks and solvents

Gel soap

5l cans. Useful for washing off ink, and soft on the skin. The soap is biodegradable. The can comes equipped with a pump and wall bracket.

Recycling

Packaging

See paragraph : Shipping and handling.

Shipping

See paragraph : Shipping and Handling.

Recycling

The material must be recycled or disposed off according to the prevalent rules and laws.

Terms of Warranty

All spare parts and repairs for this Foscott Coding product are fully guaranteed for a period of six months from the date of start up

The warranty covers any manufacturing defects - the following are excluded from the warranty:

- Non-conform uses
- Use of the machine for any purpose other than the specified uses or inappropriate uses of the machine
- Defective or incorrect electric power supply
- Wear and tear
- Defective maintenance
- Breakdown caused by non-observance of points in user manual
- Breakdown due to equipment not included in the manual
- Repairs without Foscott intervention or prior authorization of Foscott
- Use of non- Foscott Coding spare parts

The warranty is effective after prior agreement, at the client site (by our services or by the client) and includes replacing the defective parts. Packaging and shipping costs are to be borne by the client.

No compensatory damages will be due for any consequential or incidental losses incurred.